

**ALMAG Aluminum**  
SMARTER · BETTER · FASTER



Barclay's Concourse, Brooklyn NY

## Architectural Lighting

### Bright ideas for beautiful spaces

ALMAG Aluminum's "whatever it takes" approach to custom aluminum extrusion gives lighting designers the freedom to push it. If you can imagine it, ALMAG can design, extrude, fabricate and finish it.

ALMAG is an ISO 9001 certified single-source aluminum extrusion company specializing in complex, thin wall, tight tolerance and high visual aluminum extrusions.



# Architectural Lighting

Create the right environment with task, ambient or accent lighting.

## COMMON CHALLENGES

- **Fit** — Designers need to see the best constructed versions of their ideas, meaning flush connections and uniform spacing to ensure a proper fit for assembly and part function.
- **Weight** — Optimizing profile design by tailoring wall thickness can reduce the weight of heavy fixtures.
- **Look** — Architects, Engineers and Designers want clean lines, smooth textures and finishes that enhance their products' aesthetics.
- **Value Engineering** — No matter how unique a product engineer's idea is, they need to know it can be manufactured cost-effectively.

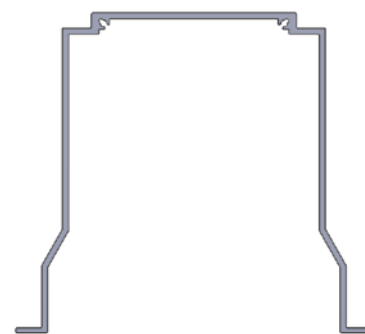

CRITICAL GAP TOLERANCE

## THE ALMAG APPROACH

- **SMARTER QUALITY CONTROL** — Test for fit, form and function with an ALMAG 3D Prototype before hard tooling begins. Know that ALMAG's measurement technology will ensure precision gap tolerances and ease of assembly.
- **BETTER DESIGN** — Lighten your designs with wall thickness as low as 0.020". Sharpen the look of every piece with advanced die design that reduces visible extrusion lines.
- **FASTER ASSEMBLY** — Let ALMAG engineers work with you to incorporate functions like screw ports, pivot points and snap fits that reduce part count and assembly time.

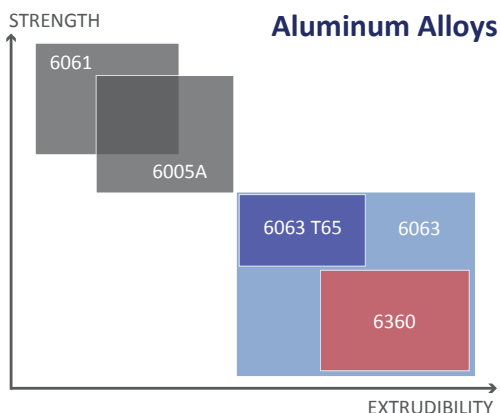

Material design for lighting profiles

DESIGN • EXTRUDE • FABRICATE • FINISH

### What are your most pressing needs?

Contact us at 1.888.462.5624 or at [extrusions@almag.com](mailto:extrusions@almag.com).

### Want more illumination?

Learn more about ALMAG's architectural lighting solutions and the other industries we serve online.

[almag.com](http://almag.com)



22 Finley Road  
Brampton ON L6T 1A9  
Canada

25452 Brewer Drive  
Ardmore AL 35739  
USA